

无极灯专用滤波器

当低碳、绿色、节能成为全社会共识，照明行业领域中的变革随之展开。“无极灯”作为新型节能照明产品，正逐渐成为绿色照明的趋势性产品，在越来越多的节能改造工程中被采纳应用。然而，无极灯的工作原理导致无极灯产品在实际应用中存在不可回避的电磁兼容问题。

因此，我公司针对低频无极灯、高频无极灯专门开发了 RD60、RD70 系列无极灯专用滤波器，并已有多款采用此滤波器的无极灯产品成功登陆并畅销包括德、法在内的欧盟市场，并通过 GS 认证。

滤波器外观图

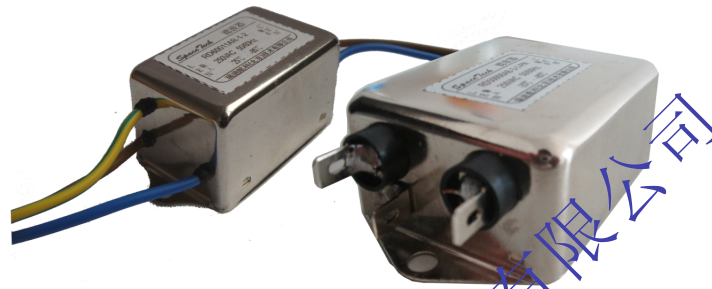

技术参数

额定电压	250 VAC, 50/60 Hz, 400VDC
额定电流	1A @ 40°C
耐压	1750 VDC, 1 min (line/line)
	2000 VAC, 1 min (lines/case)
漏电流	< 5 mA @ 250 VAC, 50 Hz
MTBF	>0.2 Millon hours @ 40°C/230V
环境等级	-25°C/+ 85°C(25/85/21 HPF)

基本电路

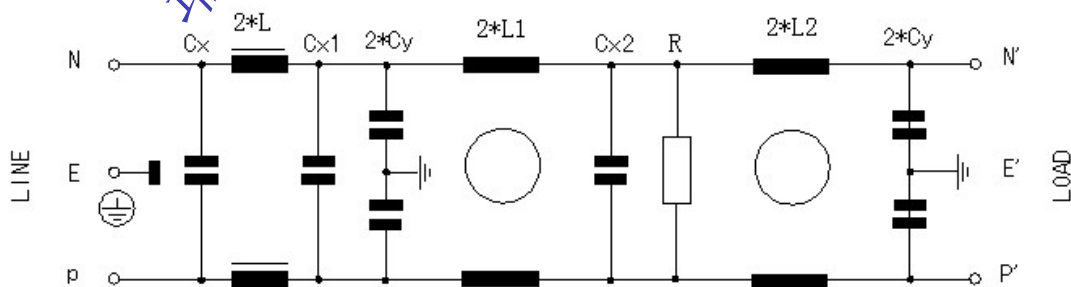

滤波器型号说明

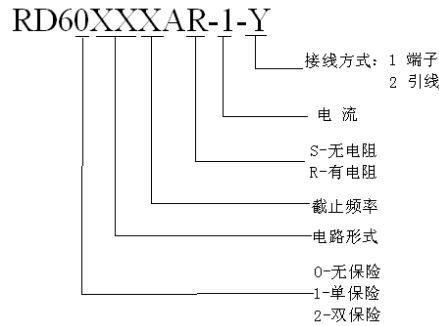

产品选择

型号	额定电流 A @ 40℃	电路形式	截止频 f_c [kHz]	接线方式 Y	功率 P[w]
RD60011AR-1-2	1	01	5	2	40
RD60021AR-1-2	1	02	5	2	60
RD60031AR-1-2	1	03	5	2	80
RD60041AR-1-2	1	04	5	2	120
RD60051AR-1-2	1	05	5	2	150
RD60061AR-1-2	1	06	5	1	200

备注：以上型号针对低频无极灯，高频型号表示为 RD70

滤波器外壳尺寸图

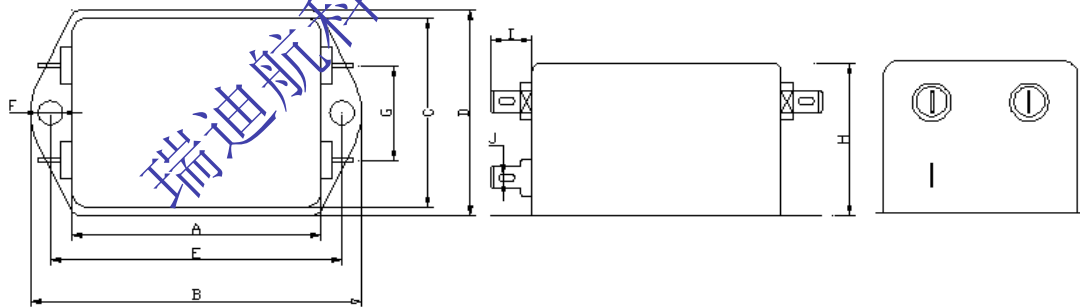

单位: mm

尺寸 型号	A	B	C	D	E	F	G	H	I	J
小号	51.5	70.4	33.2	37.2	58.2	4.5	19.5	29.0	0	0
中号	50.5	72.7	50.5	54.5	60.0	5.8	25.0	30.0	15.0	2.0
大号	63.0	84.8	51.0	55.0	71.6	5.8	25.0	29.0	15.0	2.0

典型插入损耗: (按 CISPR1 在 50Ω/50Ω 条件下测试)

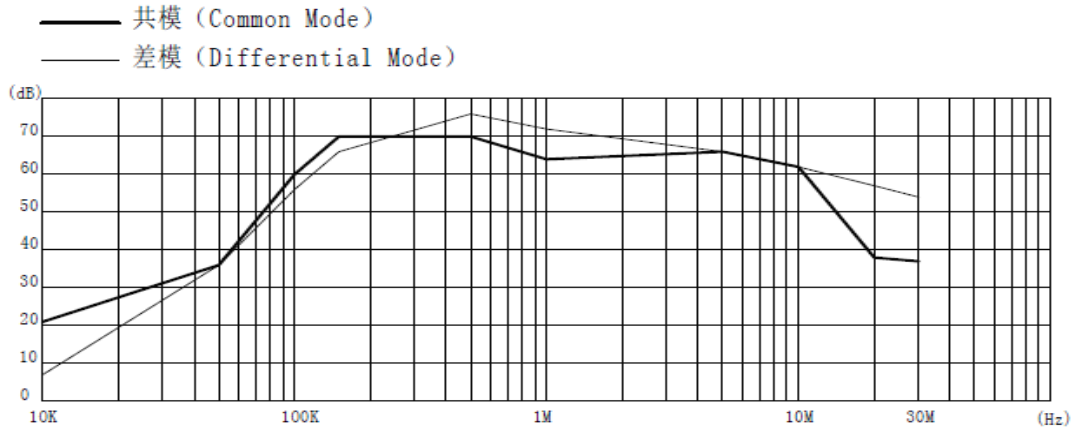

RD60011AS-1-2

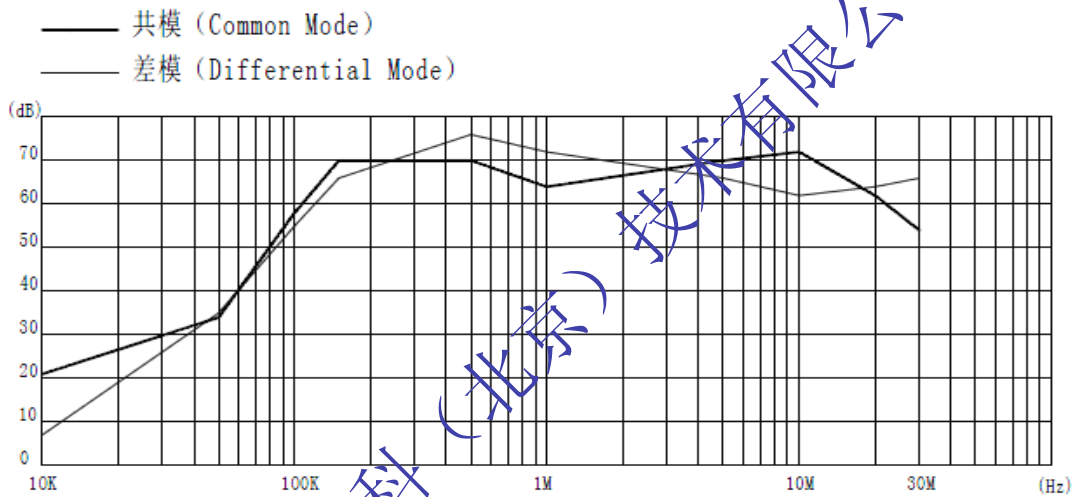

RD60021AS-1-2

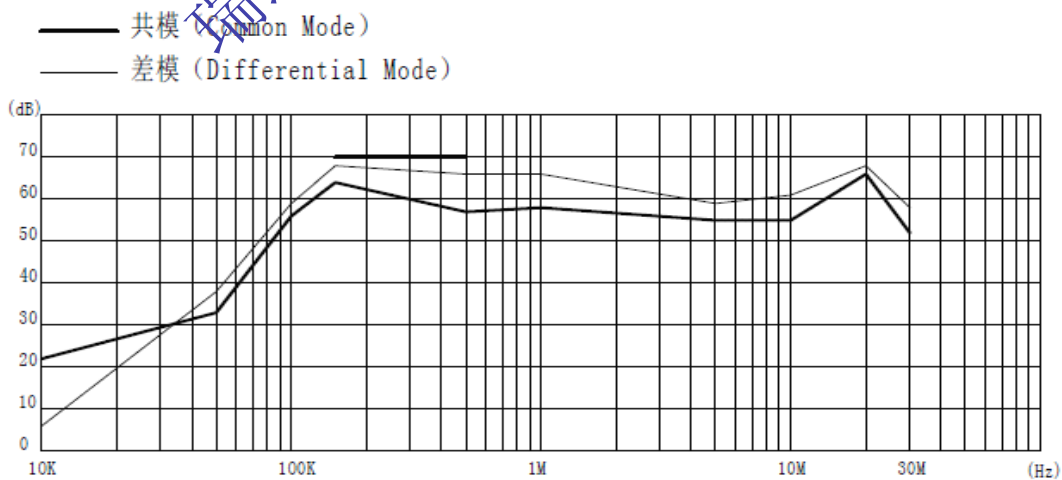

RD60031AS-1-2

低频滤波器典型插入损耗: (按 CISPR1 在 50 Ω/50 Ω 条件下测试)

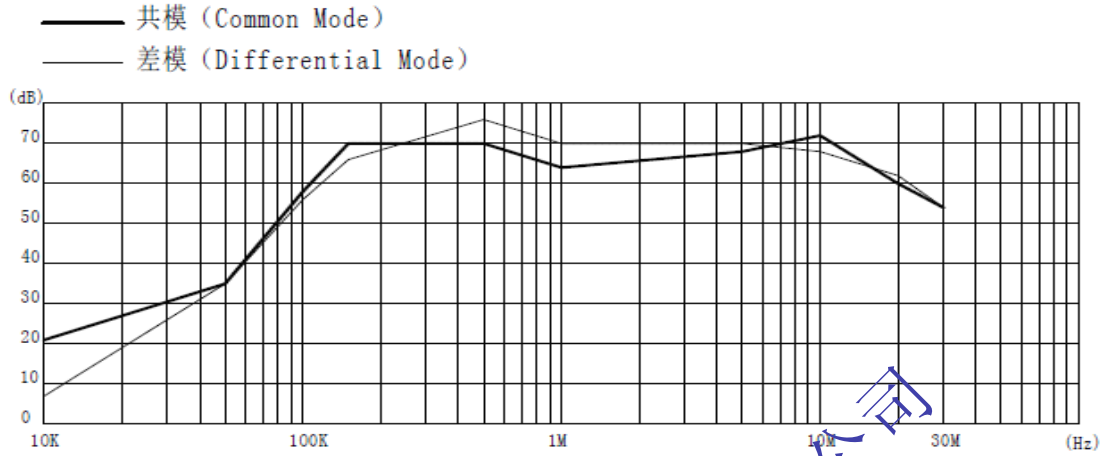

RD60041AS-1-2

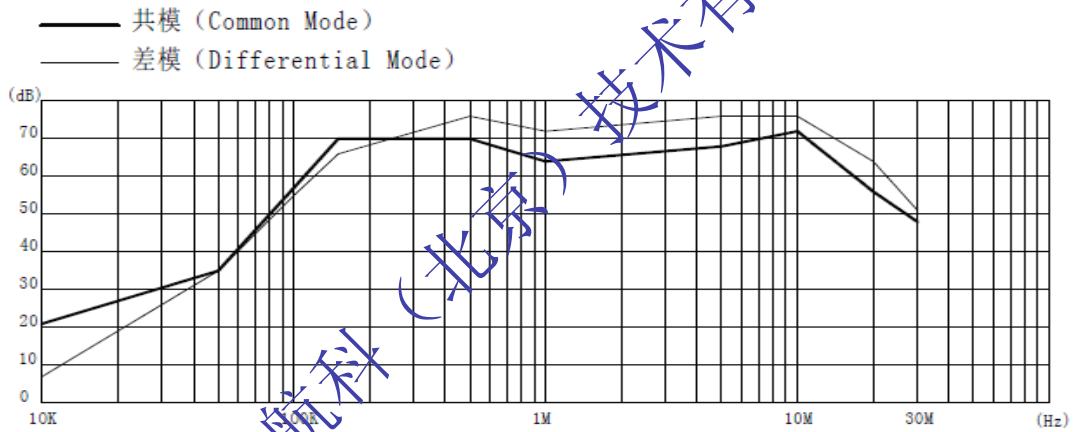

RD60051AS-1-2

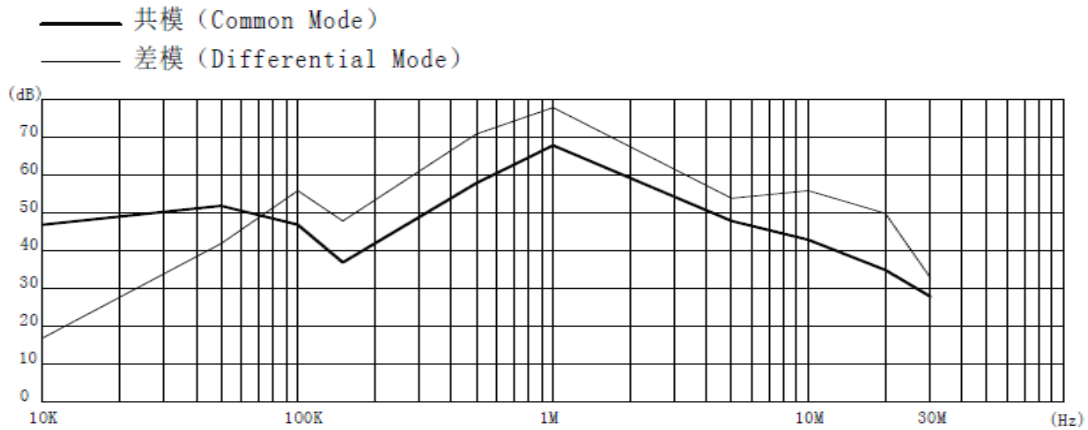

RD60061AS-1-2

高频滤波器典型插入损耗：（按 CISPR1 在 50Ω/50Ω 条件下测试）

200W

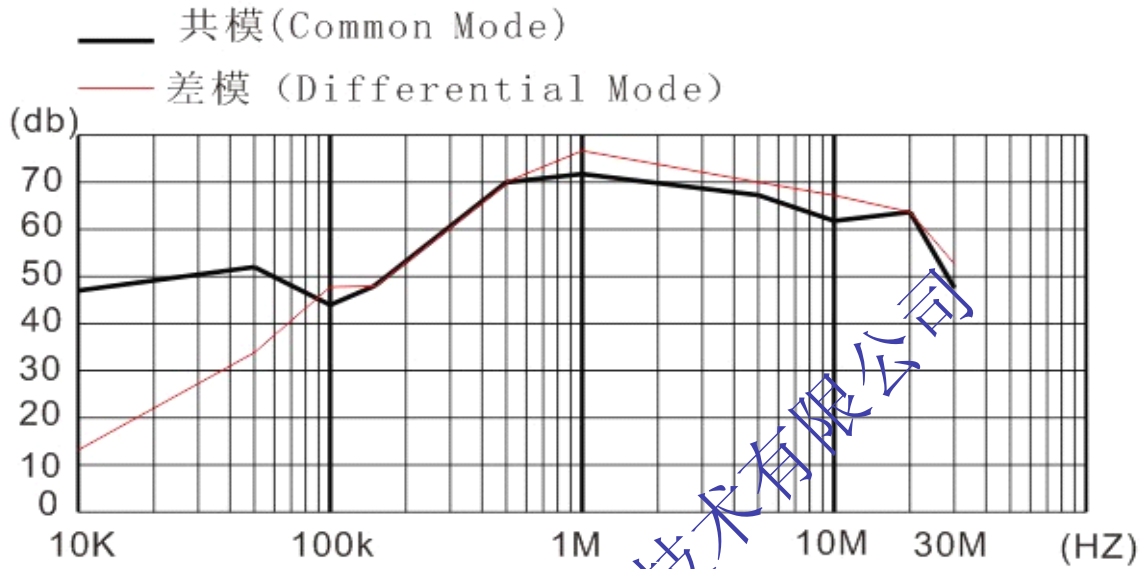

RD70061AR-1-2

瑞迪航科(北京)技术有限公司

IEC 医用滤波器



医用滤波器

技术参数

额定电压 V_R	250 VAC, 50/60 Hz, 400VDC
额定电流 I_R	1A — 15A @ 40°C
耐压 V_p	医用型号 1750 VDC, 1 min (line/line) 2500 VAC, 1 min (lines/case)
漏电流 I_{leak}	医用型号 < 0.5 mA @ 250 VAC, 50 Hz
MTBF	>0.2 Million hours @ 40°C/230V
环境等级	-25°C/+ 85°C (25/85/21 HPF)

电路图

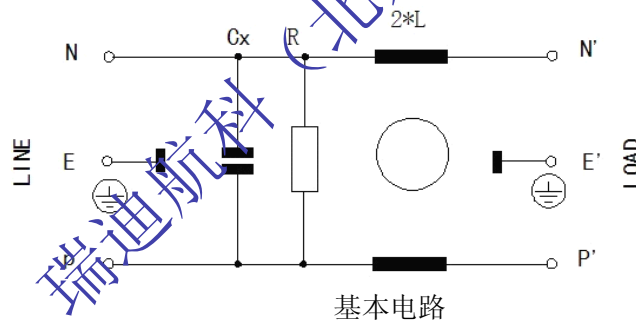

产品选择

型号	额定电流 A @ 40°C	电路形式	截止频率 f_0 [kHz]	接线方式
RD500110AB-1-1	1	01	5	1
RD500210AB-3-1	3	02	5	1
RD500310AB-6-1	6	03	5	1
RD500410AB-8-1	8	04	5	1

RD500510AB-10-1	10	05	5	1
RD500610AB-12-1	12	06	5	1
RD500710AB-15-1	15	07	5	1
RD520110AB-1-1	1	01	5	1
RD520210AB-3-1	3	02	5	1
RD520310AB-6-1	6	03	5	1
RD520410AB-8-1	8	04	5	1
RD520510AB10-1	10	05	5	1
RD520610AB12-1	12	06	5	1
RD520710AB15-1	15	07	5	1

型号说明

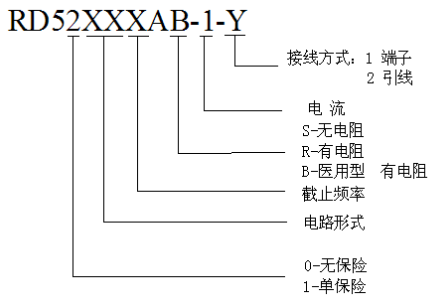

滤波器外壳尺寸 (mm) 图

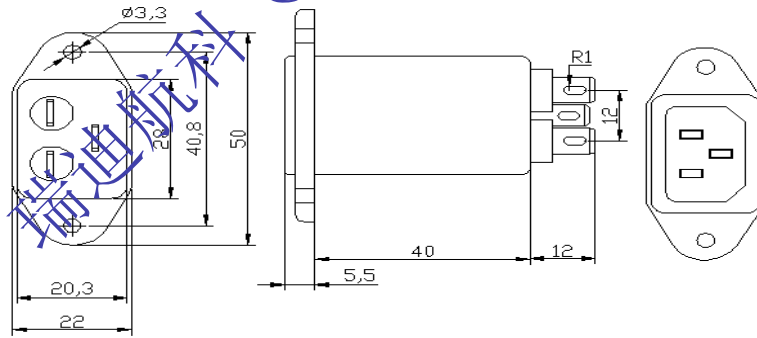

无保险丝滤波器外壳尺寸图

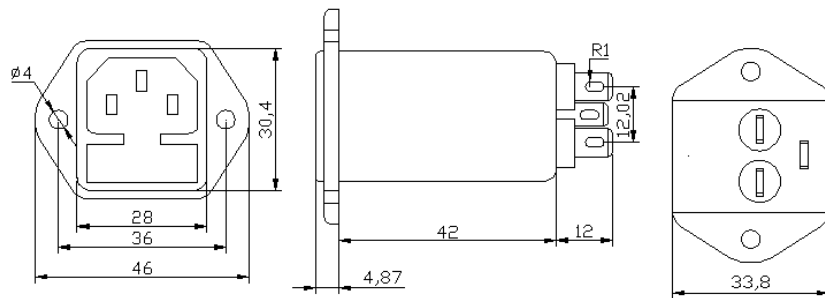

双保险丝滤波器外壳尺寸图

典型无保险掺入损耗：(按 CISPRI 在 50Ω/50Ω条件下测试)

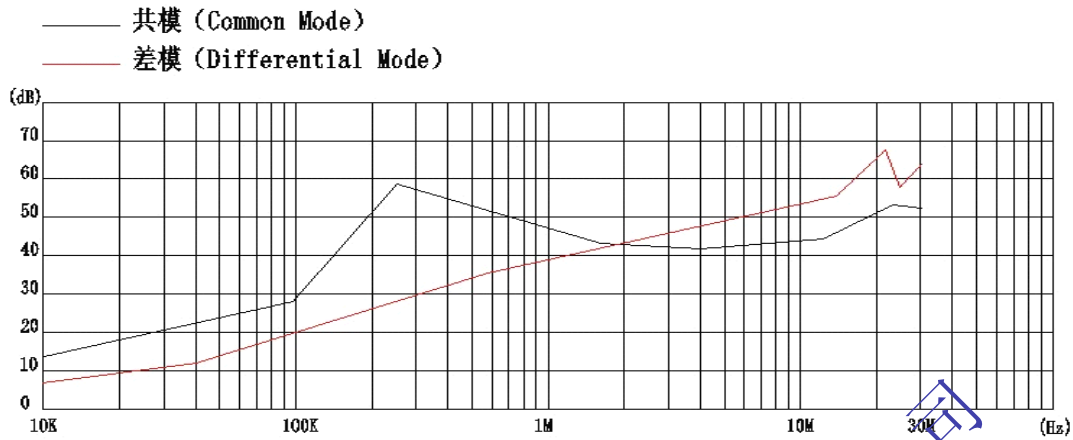

1A and 3A types

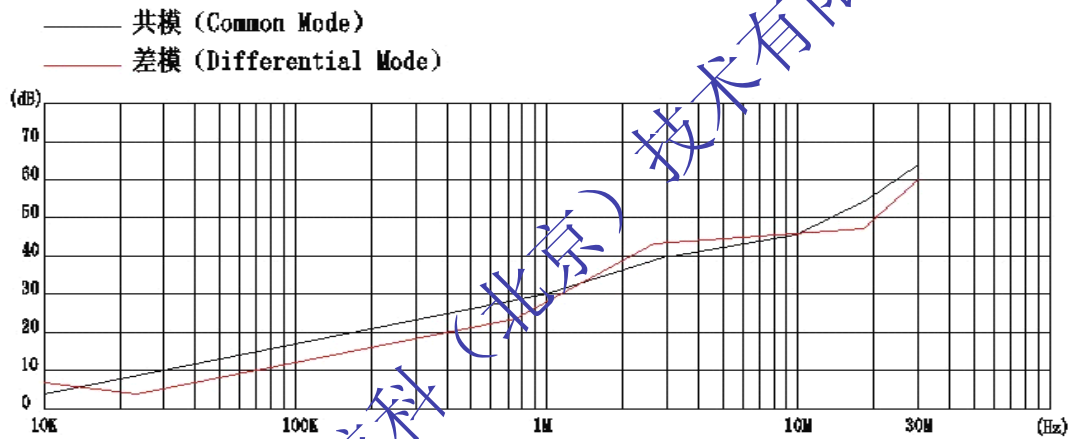

6A to 10A types

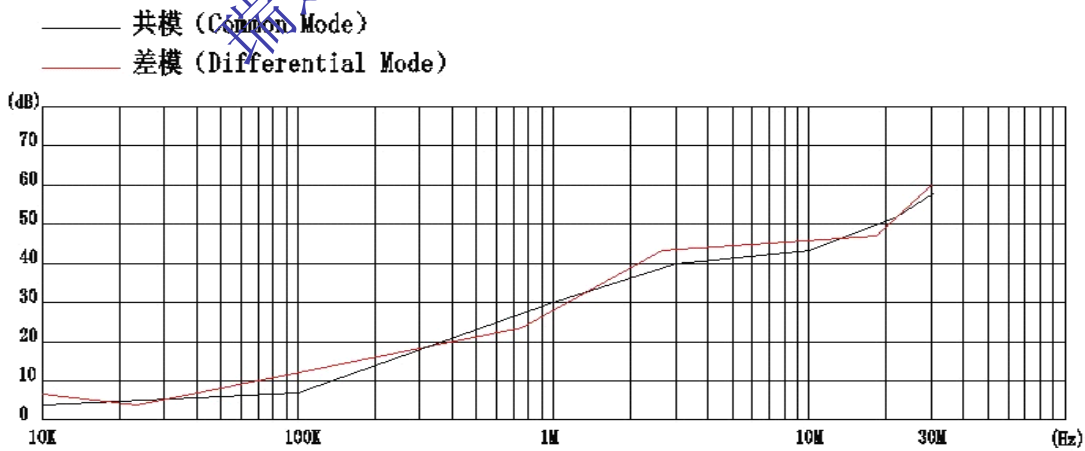

12A and 15A types

典型有保险掺入损耗：(按 CISPRI 在 50Ω/50Ω条件下测试)

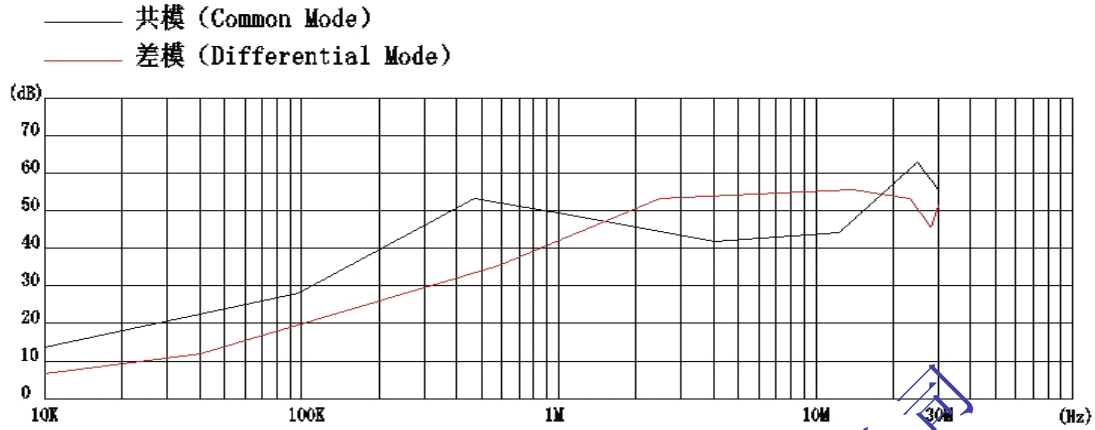

1A and 3A types

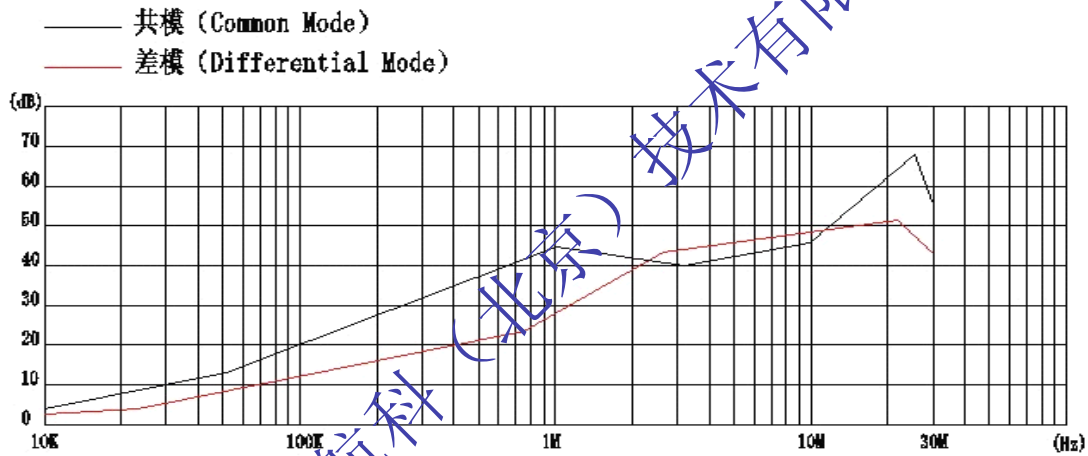

6A to 10A types

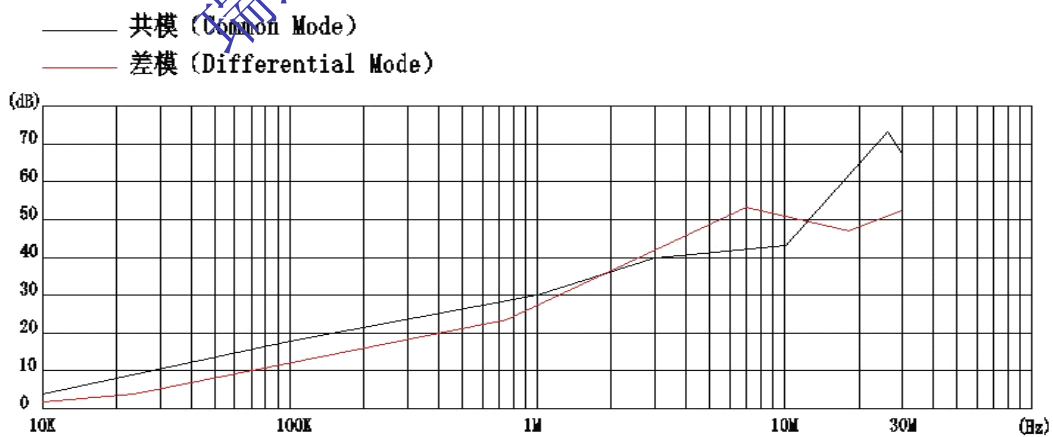

12A and 15A types

IEC 通用滤波器



技术参数

额定电压 V_R	250 VAC, 50/60 Hz, 400VDC
额定电流 I_R	1A — 15A @ 40°C
耐压 V_P	标准型号 1750 VDC, 1 min (line/line)
	2000 VAC, 1 min (lines/case)
漏电流 I_{leak}	标准型号 < 5 mA @ 250 VAC, 50 Hz
MTBF	>0.2 Million hours @ 40°C/230V
环境等级	-25°C/+ 85°C (25/85/21 /PP)

电路图

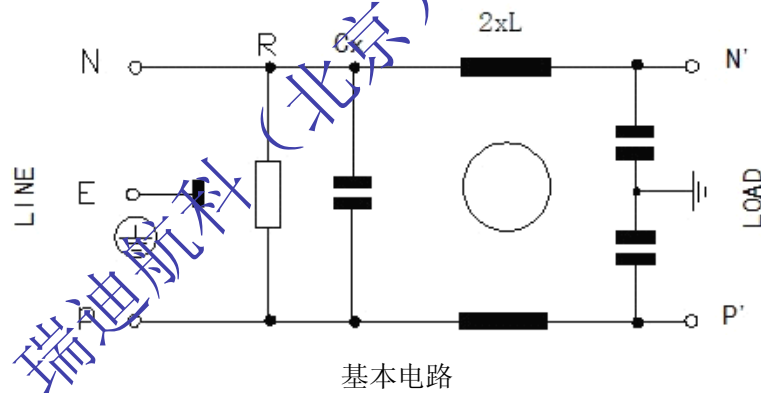

产品选择

型号	额定电流 A @ 40 °C	电路形式	截止频 f_c [kHz]	接线方式
RD51011AS-1-1	1	01	5	1
RD51021AS-3-1	3	02	5	1
RD51031AS-6-1	6	03	5	1

RD51041AS-8-1	8	04	5	1
RD51051AS-10-1	10	05	5	1
RD51061AS-12-1	12	06	5	1
RD51071AS-15-1	15	07	5	1
RD51011AR-1-1	1	01	5	1
RD51021AR-3-1	3	02	5	1
RD51031AR-6-1	6	03	5	1
RD51041AR-8-1	8	04	5	1
RD51051AR10-1	10	05	5	1
RD51061AR12-1	12	06	5	1
RD51071AR15-1	15	07	5	1
RD50011AS-1-1	1	01	5	1
RD50021AS-3-1	3	02	5	1
RD50031AS-6-1	6	03	5	1
RD50041AS-8-1	8	04	5	1
RD50051AS-10-1	10	05	5	1
RD50061AS-12-1	12	06	5	1
RD50071AS-15-1	15	07	5	1
RD50011AR-1-1	1	01	5	1
RD50021AR-3-1	3	02	5	1
RD50031AR-6-1	6	03	5	1
RD50041AR-8-1	8	04	5	1
RD50051AR-10-1	10	05	5	1
RD50061AR-12-1	12	06	5	1
RD50071AR-15-1	15	07	5	1

型号说明

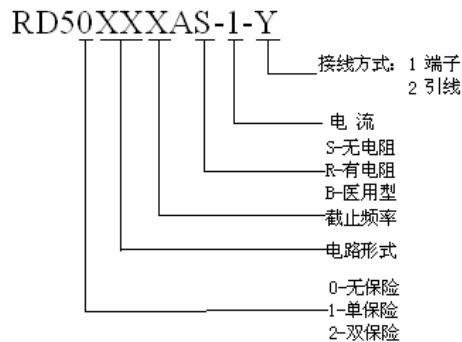

滤波器外壳尺寸 (mm) 图

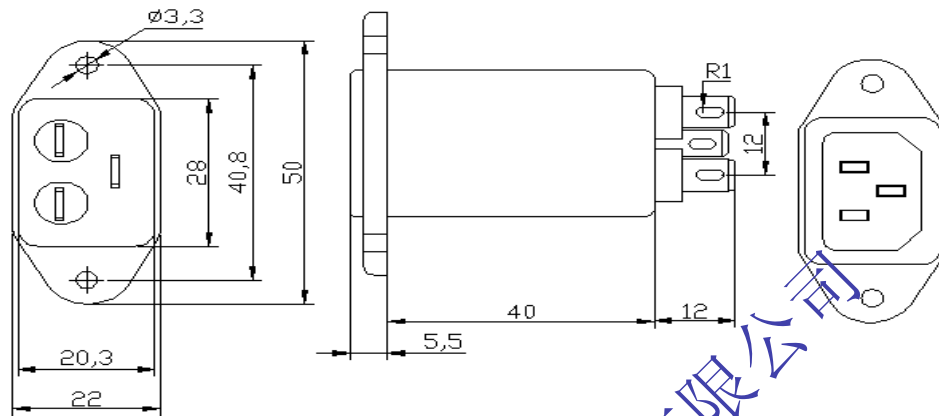

无保险丝滤波器外壳尺寸图

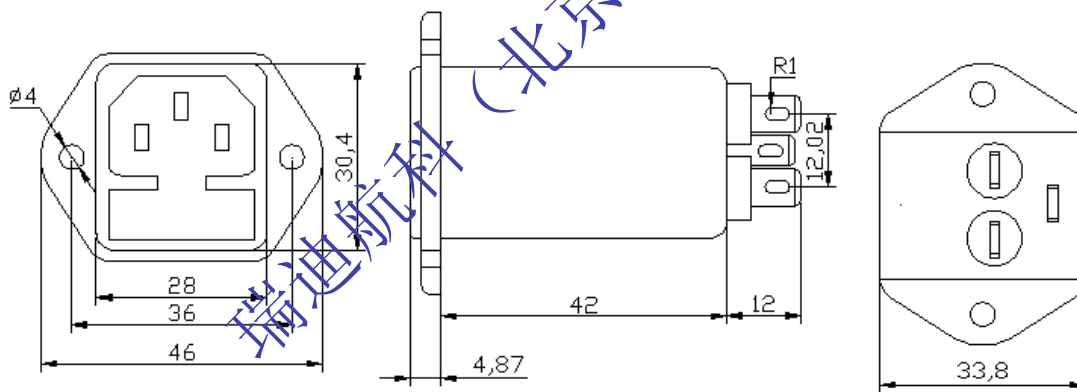

单保险丝滤波器外壳尺寸图

典型无保险掺入损耗：(按 CISPRI 在 50Ω/50Ω条件下测试)

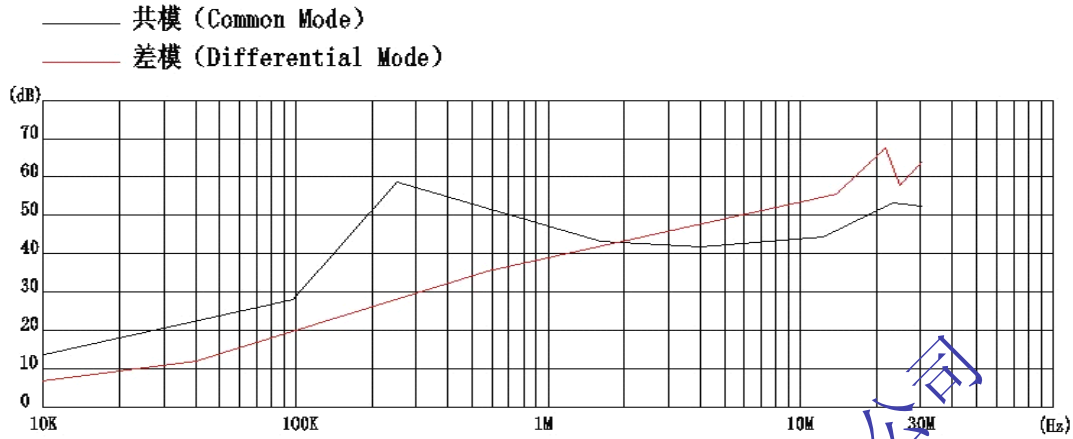

1A and 3A types

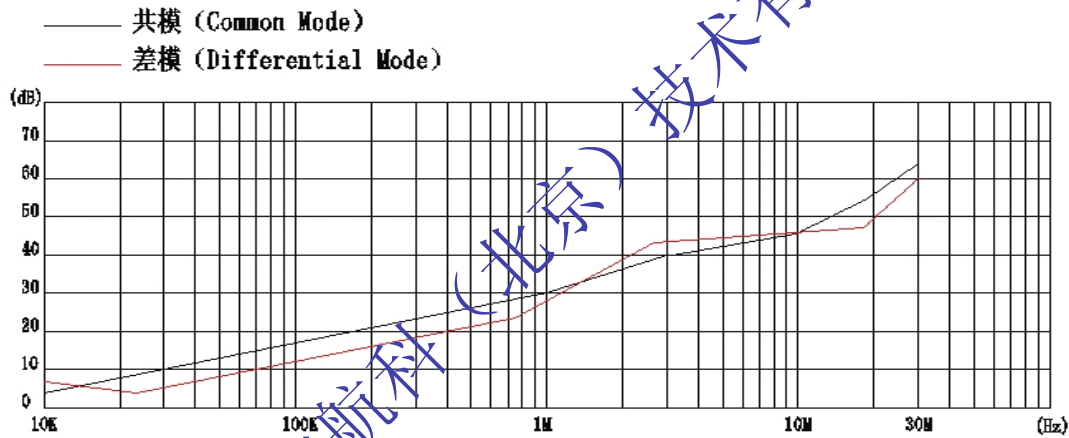

6A to 10A types

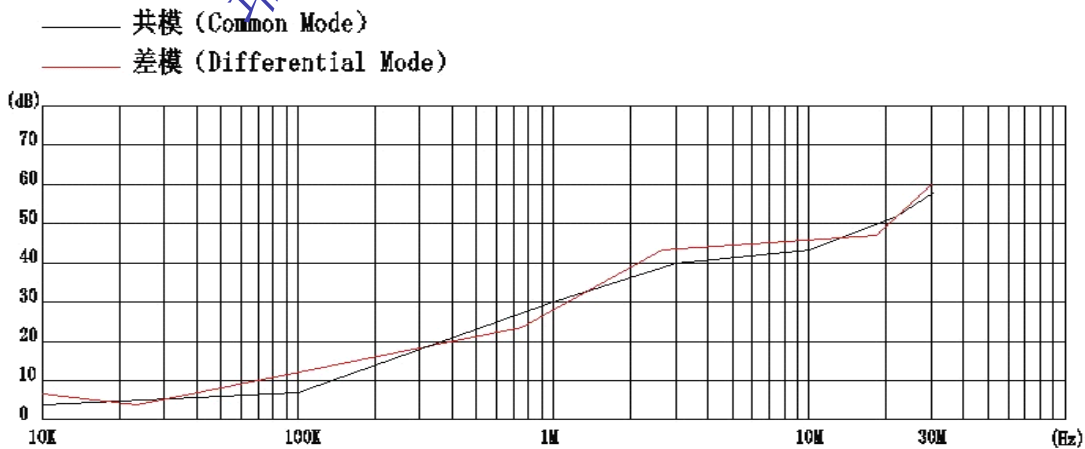

12A and 15A types

典型有保险掺入损耗：(按 CISPRI 在 50Ω/50Ω条件下测试)

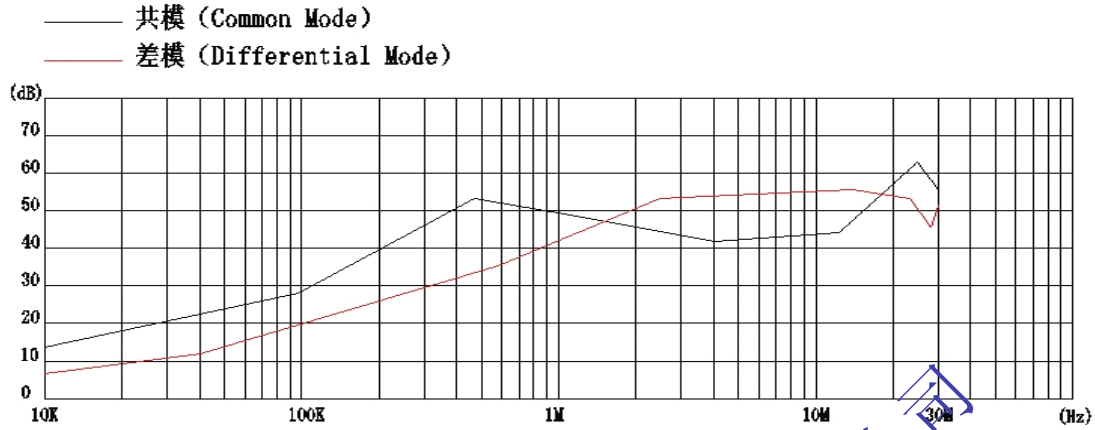

1A and 3A types

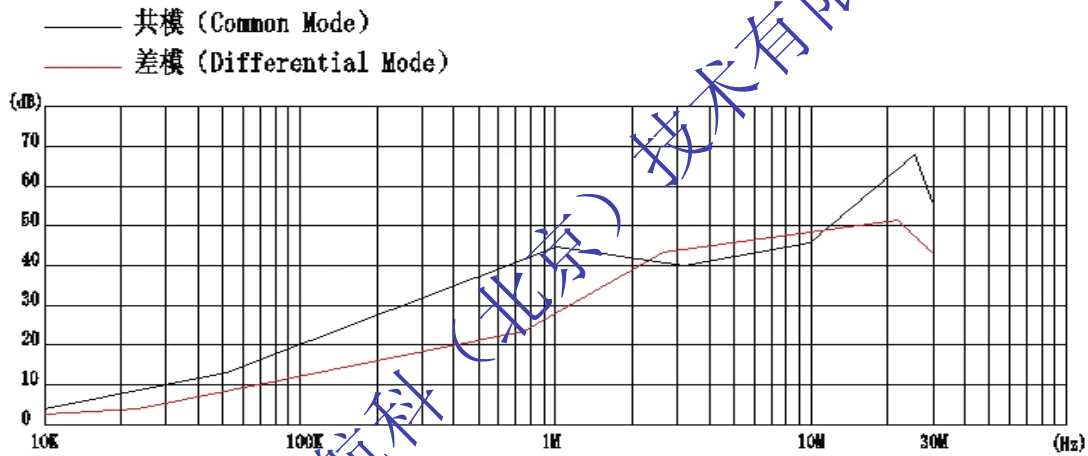

6A to 10A types

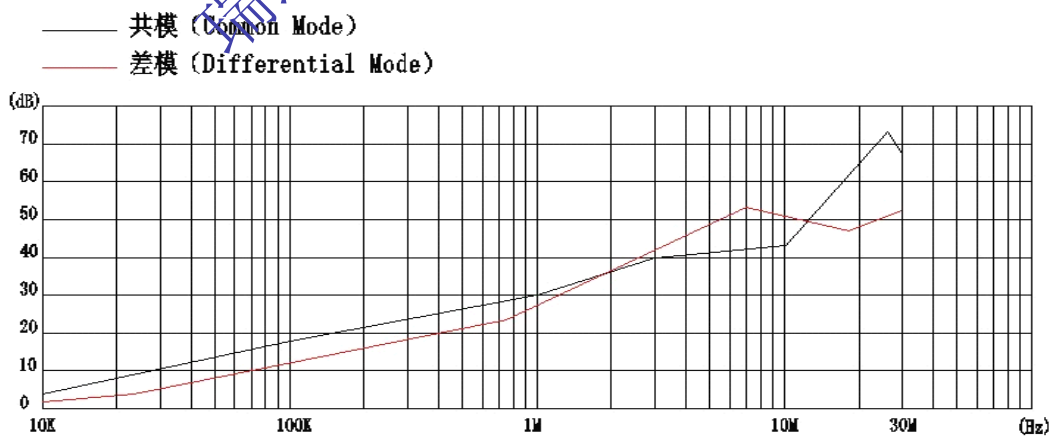

12A and 15A types

瑞迪航科(北京)技术有限公司

商务办公: 北京石景山区金顶东街1号金顶科技园312室(100041)

生产基地: 北京大兴开发区垡上工业园南区15号

电话: 400-6800-965 010-88754189 010-88754188

联系人: 吴先生

传真: 010-88754190

邮件: china@rdcoo.com

网址: www.rdcoo.com

瑞迪航科(北京)技术有限公司